



**SOCIAL SCIENCE RESEARCH AND INSTRUCTIONAL COUNCIL**

And

California State University

Present

**The 42<sup>nd</sup> annual**

**Social Science Student Symposium (S<sup>4</sup>)**

April 27, 2017

California State University, Fresno

Special thanks to the Department of Sociology, College of Social Sciences, and Sociology Club, CSU-Fresno

## Registration and Welcoming Remarks

Time: 8:15-9:15

Location: Satellite Student Union

Registration: All presenters are required to check-in at the registration desk.

Light breakfast, and drinks to go, 8:15-9:15

(Drinks to go and light snacks available throughout the whole day.)

Welcoming Remarks, 8:30-9:15

Eugene Turner (retired), *Professor of Geography*, California State University, Northridge, and *Chair*, Social Science Research and Instructional Council

Michelle DenBeste, *Dean*, College of Social Science, California State University, Fresno

Tim Kubal, *Associate Professor of Sociology*, California State University, Fresno, and *Chair* of the symposium organizing committee

## Session 1

Time: 9:30-10:45

Location: Multiple breakout rooms

Session Topics: Culture, Criminal Justice, Education, Politics, Health

### Session 1A: Culture

9:30-10:45 University Student Union (USU), room 312

Presider/Discussant: Ed Nelson, Emeritus Professor of Sociology, CSU-Fresno

*The Divinity of Jesus in Early Christian Thought: A Historiographical Approach*

Joshua Tanis, History undergraduate student, CSU Stanislaus

*The Power of Art in Prisons*

Hannah Riccardi, Criminology undergraduate student, CSU-Fresno

*Affrication in Qassimi Arabic*

Alrashed Abdulmajeed, Linguistics graduate student, California State University, Fullerton

*Social Interaction and Facebook Activity: Social Isolation as it Relates to Non-interaction*

Joseph Dov, Sociology undergraduate student, California State University, Long Beach

### **Session 1B: Criminal Justice (Part 1)**

9:30-10:45 University Student Union (USU), room 313

Presider/Discussant: Jenna Kieckhaefer, Assistant Professor of Criminology, California State University, Fresno

*Public Perceptions of Exonerees from the Criminal Justice System*  
Shelby Elia, Public Administration graduate student, CSU  
Fresno

*AB 109 and How it Impacted California Criminal Justice System*  
Cheenou Xlong, Criminology undergraduate student, CSU  
Fullerton

*The Impact of Veteran's Mental Health and Offense Severity on Admissibility into Veterans Treatment Court*  
Samantha Luna, Criminology undergraduate student, CSU Fresno

### **Session 1C: Education (Part 1)**

9:30-10:45 University Student Union (USU), room 314

Presider/Discussant: Nancy Hudspeth, Assistant Professor, CSU Stanislaus

*Does Merit-Based Aid Influence Students' Tendencies to seek Graduate Degrees? A Statistical Analysis*  
Salahuddin Temueri, Political Science undergraduate student, CSU-San Francisco

*Completing the graduate degree: the effect of student satisfaction with advisors on time to degree (TTD)*  
Ian Klinger, Sociology graduate student, CSU-Dominguez Hills

*How does Income, Race, and Religion Affect Educational Levels of Attainment?*  
Murat Ince, Sociology undergraduate student, CSU-Fresno

*School Finance Decisions and Academic Performance: An Analysis of the Impacts of School Expenditures on Student Performance*  
Andrew Carhart, Public Policy and Administration graduate student, CSU-Sacramento

## Session 1D: Politics (Part 1)

9:30-10:45 Henry Madden Library, (HML) room 2127

Presider/ Discussant: Francis Neely, Professor of Political Science, San Francisco State University

*The Myth of Cleopatra: Shrewd Sovereign or Wanton Woman*

Rebecca Rooker, History Undergraduate Student, CSU-Stanislaus

*Colonial Privateers: War and Trade During the American Revolution, 1775-1777*

Edgar Bolanos History undergraduate student, CSU-Fresno

*Hopes, Fears, and Expectations: The Ottoman Empire and the Outbreak of the First World War*

Armen Manuk-Khaloyan, History Graduate Student, CSU-Northridge

*America's Paradise Lost: The Abuse of Micronesia in the Name of Global Security*

Taylor Trummel Political Science Undergraduate Student, CSU- San Diego

## Session 1E: Health

9:30-10:45 Henry Madden Library (HML), room 2206

Presider/Discussant: Stafford Cox, Academic Technology Services, California State University Long Beach

*Race, Education, and Socioeconomic Impact on Breastfeeding Mothers*

Nicole Prekop, Sociology undergraduate student, CSU- Fresno

*The Correlation between Religiosity and Adolescent Sexual Promiscuity*

Ana Celestino, Health Sciences undergraduate student, CSU-Dominguez Hills

*Cross-Cultural and Ethnical Differences and Similarities in Visual Attention among Japanese, Caucasian, and Hispanic Children*

Candace Teran Health, Human Services, and Nursing undergraduate student CSU Dominguez Hills

*Creating a Space to Call Their Own: Birth Workers of Color and Abuelita Knowledge in Los Angeles County.*

Stevie Merino, Anthropology graduate student, CSU- Long Beach

## Session 2

Time: 11:00-12:15

Location: Multiple breakout rooms

Session Topics: Family, Crime, Education, Politics, Race

### **Session 2A: Family**

11:00-12:15 University Student Union (USU), room 312

Presider/Discussant: Jennifer Randles, Associate Professor of Sociology, CSU-Fresno

*Mental Illness and the Foster Care System*

Alexander S. Bony, Psychology undergraduate student, CSU-Fresno

*Gendered Pairing Patterns in Interracial Marriages*

Thais Forneret, Sociology graduate Student, CSU-Sacramento

*Possible Associations between Perceived Parenting Behaviors and Adolescent Reliance on Religious Teachings*

Gabriela Massie, Health Sciences undergraduate student, CSU-Dominguez Hills

### **Session 2B: Criminal Justice (Part 2)**

11:00-12:15 University Student Union (USU), room 313

Presider/Discussant: Andrea Arndorfer, Assistant Professor, Department of Criminology, California State University, Fresno

*The Association between Life Stress and Adolescent Substance Use*

Emily Coviello, Health Sciences undergraduate student, CSU-Dominguez Hills

*Golden State of Corrections: A County-by-County Analysis of Socioeconomic Factors on Incarceration and Recidivism Rates*

Jordyn Markoe, Political Science undergraduate student, CSU-San Francisco

*Police Structure and Staffing in Response to the 2007 Market Crash*

Ernesto Lopez, Politics, Administration, and Justice graduate student, CSU-Fullerton

*Masculinity and Law Enforcement in Fresno, CA*

Cinthia Quesada, Sociology undergraduate student, CSU-Fresno

### **Session 2C: Education (Part 2)**

11:00-12:15 University Student Union (USU), room 314

Presider/Discussant: Jenny Banh, Assistant Professor, CSU-Fresno

*Social Factors Surrounding Sleep Among Fresno State Students*

Chi Chang, Anthropology undergraduate student, CSU-Fresno

*Student Talking About Race (S.T.A.R): An evaluation of the program*

Tanjeem Afreen, Anthropology graduate student, CSU-Long Beach

*The Undercurrent of Bohemian Grove, the Business of Diversity, and the Corporate (Post Affirmative Action) University: A Mix-Methods Discovery Expanding on the Theoretical Framework of (Subramanian, Perrucci and Whitlock's) Intellectual Closure (2014).*

David Ortuno, Sociology Undergraduate Student, CSU San Marcos

*The Effect of Student Satisfaction on Student Loan Default*

Jennifer Skornik, Sociology graduate Student, CSU-Northridge

## **Session 2D: Politics (Part 2)**

11:00-12:15 Henry Madden Library (HML), room 2127

Presider/ Discussant: Francis Neely, Professor of Political Science, San Francisco State University

*Challenging the Stained Glass Ceiling: Exploring Political Participation among Women in the Evangelical Church*

Rachael Cole, Sociology Graduate Student CSU-San Jose

*"Youth, Globalization and Extremism in the Middle East" Advancing Data Science in Research, Analysis and Decision Making*

Natascha Bolden, Political Science Graduate Student, CSU San Bernardino

*The World's Panthers: Who the Black Panther Party Supported Abroad and Why*

David Hollingsworth, History graduate student, CSU-San Diego

## **Session 2E: Race**

11:00-12:15 Henry Madden Library (HML), room 2206

Presider/Discussant: Aya Ida, Professor of Sociology, California State University, Sacramento

*Analyzing Race and Social Issues*

Devany Prieto, Sociology undergraduate student, CSU-Fresno

*The Racial Divide: Perceptions of Crime, the Death Penalty, Police Misconduct, Food Insecurity, and Economic Inequality*

Amber Pinzon, Sociology undergraduate student, CSU-Fresno

*The Continuum of Racial Discrimination Shaping American Lives Through Police Tactics, Immigration, Poverty, and Other Social Issues*

Diana Arenivas, Sociology undergraduate student, CSU-Fresno

*Race and Social Class Effects on Inequality, Homelessness, Crime, & Police*

Elisa Ulloa, Biology undergraduate student, CSU-Fresno

## Lunch and Keynote Address

Time: 12:30 -1:50

Location: Satellite Student Union (SSU)

Buffet Lunch, 12:15-1:15 (for presenters, presiders, and mentors)

Taco Bar (chicken or fish), salad, seafood and vegetarian appetizers, iced tea, coffee, dessert

Keynote address, 1:15-1:50

Mark DiCamillo is the former director of the Field Poll and is currently the director of the UC Berkeley Institute of Governmental Studies (IGS) Survey. He will be speaking on "The 2016 election and what it means for Polling."

## Session 3

Time: 2:00-3:15

Location: Multiple breakout rooms

Topics: Demography, Psychology, Politics, Inequality

### Session 3A: Demography

2:00-3:15, University Student Union (USU) 312

Presider/Discussant: Brian Gillespie, Assistant Professor of Sociology, Sonoma State University

*The Creation of a Modern Estonian Identity: The Role of a Selective History, Ethnic Minorities, and Multilateral Organizations*

Taylor Trummel, Political Science undergraduate, CSU- San Diego

*Americans' Attitudes on Immigration*

Aziz Waziri, Sociology undergraduate, CSU-Sacramento

*What we know about the Hmong refugee crisis of decades past and how it can help us predict trends in the current Syrian refugee crisis.*

Sheila Her, Political Science Undergraduate, CSU-Fresno

### **Session 3B: Psychology**

2:00-3:15, University Student Union (USU) 313

Presider/Discussant: Aya Ida, Professor of Sociology, California State University, Sacramento

*Diminished Levels of Personal Control in Lower Class Americans*

Amanda Amaro, undergraduate student, Political Science, CSU-San Francisco

*The Role of Heart Generated Electrical Activity in Decision-Making*

Olivia Krieger Psychology Undergraduate Student, CSU- Sonoma

*The Disappearance of the Middle Class and Political Efficacy in the United States*

Amanda Amaro Political Science Undergraduate Student, CSU-San Francisco

*Liberation Psychology: A Transpersonal Response to Systemic Oppression*

Jodi Scofield Psychology Undergraduate Student CSU Los Angeles

### **Session 3C: Politics (Part 3)**

2:00-3:15, University Student Union (USU) 314

Presider/Discussant: Melanie Ram, Associate Professor of Political Science, California State University, Fresno

*WEARING THE PANTS: The Embodied Experiences of Women in the U.S. Coast Guard and Fire Service*

Stephanie Chapman, Sociology undergraduate student, CSU-Sonoma

*Preemptive Federalism: The Banking Dilemma Facing State Legal Marijuana Laws*

Richard Kemp, Political Science graduate student, CSU Bakersfield

*Feelings on Global Warming as Related to Income In The United States (2006-2012)*

Guillermo Garcia Political Science Undergraduate Student, CSU- San Francisco

### **Session 3D: Politics (Part 4)**

2:00-3:15, Henry Madden Library (HML) 2127

Presider/ Discussant: Francis Neely, Professor of Political Science, San Francisco State University



*The Systematic Study of Leadership Selection in Congress*

Cassandra Estrella, Political Science/ Global Studies undergraduate student, CSU-Channel Islands

*Policy Networks and Democratic Governance*

Ricardo Vieira, Political Science graduate student, CSU-San Diego

*American Efficiency: The New United States Government*

Alberto Mora, History undergraduate student, CSU-East Bay

**Session 3E: Inequality**

2:00-3:15, Henry Madden Library (HML) 2206

Presider/ Discussant: Matthew Jendian, Professor of Sociology, California State University, Fresno

*Finding Inequality within Disability, Sex, and Unemployment*

Political Science Undergraduate Student CSU San Francisco

*Food Insecurity for Californians Living in Poverty: Racial, Transportation, and Geographic Correlates (2007)*

Hannah Poore, Sociology undergraduate student, CSU-Fresno

*Food Sustainability: Comparative Analysis Between Global and Local Distribution of Produce Items*

Ariana Brandao Anthropology and Geography Undergraduate Student San Luis Obispo

*Relationship Between Food Insecurity and Low-Income Seniors in Alameda County*

Jeffrey Mosier Sociology Undergraduate Student CSU East Bay

-

**Awards Ceremony and Closing Remarks**

3:30-4:00

Satellite Student Union

Refreshments: Misc. desserts, lemonade, and coffee

Presentation of awards

Eugene Turner, *Professor of Geography* (retired), California State University, Northridge, and *Chair*, Social Science Research and Instructional Council

and

Gilbert Garcia, California State University, Los Angeles, *Chair*, Student Awards  
Committee, Social Science Research and Instructional Council

Closing remarks

Tim Kubal, Associate *Professor of Sociology*, California State University, Fresno, and  
*Chair* of the symposium organizing committee

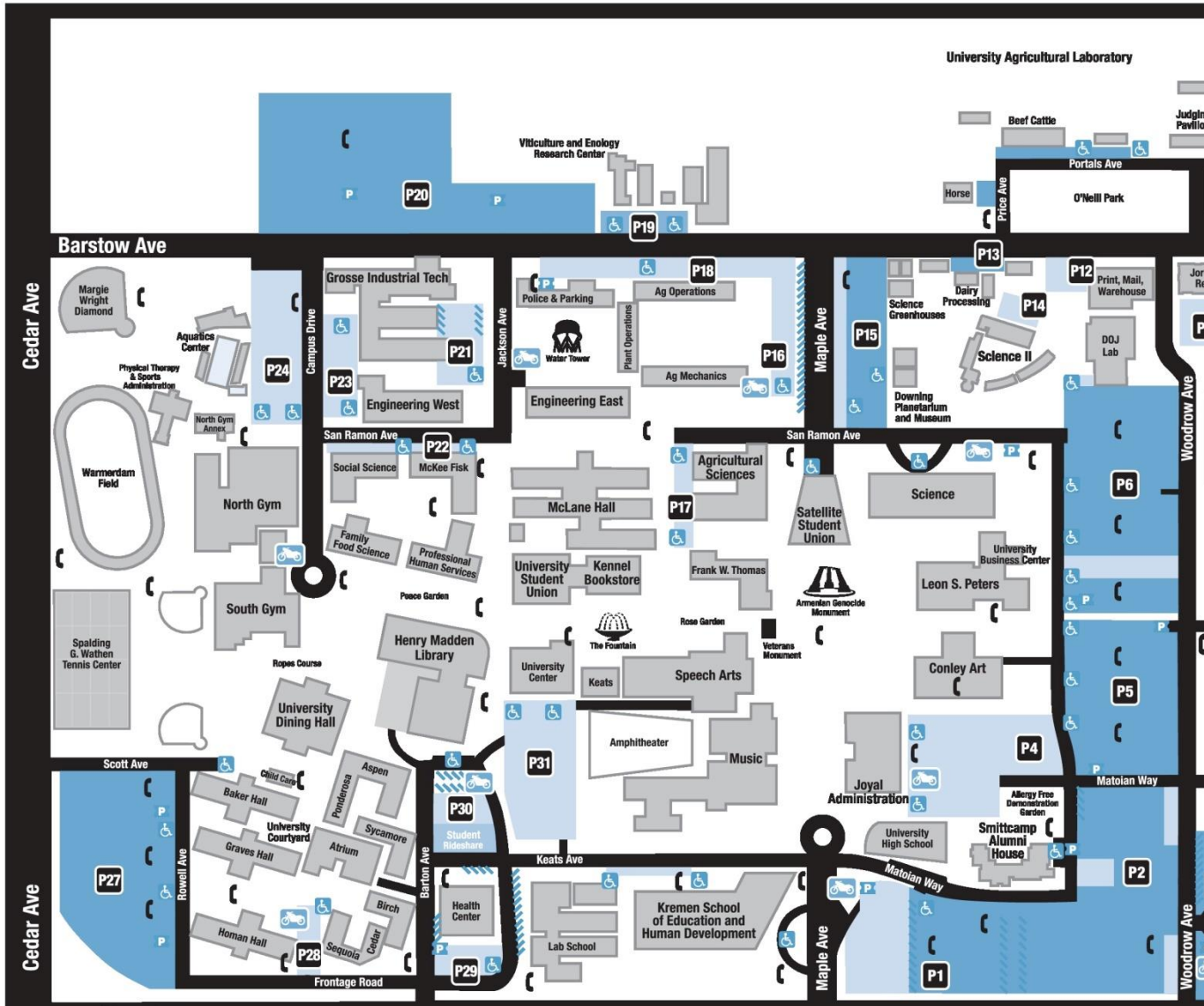

Shaw Ave

Main Entrance

**FRESNO STATE**  
Discovery. Diversity. Distinction.

<b>Green Permit</b> (Student/Visitor Parking)	<b>Blue Permit</b> (Disabled Parking)	<b>Short Term Parking</b>
<b>Yellow Permit</b> (Employee Parking)	<b>Motorcycle Parking</b>	<b>Daily Parking Permit Dispensers</b>

## Internet Access for the 2017 Social Science Student Symposium

If you are an "Eduroam" user on your home campus, you should be able to connect to "Eduroam" on the Fresno State campus.

If you are not an "Eduroam" user, you will need to get a guest account on the Fresno State campus. Here are the instructions for doing that.

### Creating a "One-day" Guest Account

Fresno State guests can create a temporary "one-day" wi-fi account to use while on campus.

1. On your device, select **Bulldogs** from the available Fresno State wi-fi networks.
2. Open a web browser and the authentication page will appear. If the authentication page does not appear, enter a common URL (e.g., msn.com) in the address bar and press **Enter** on your keyboard. The authentication page will appear afterwards.
3. Click on the "Need to register as a guest?" link located on the authentication page.
4. Fill out the request form. Be sure to include a valid cell phone number.
5. Click the **Register** button.
6. A text message with the account information is sent to the specified cell phone number.
7. Return to the Bulldogs authentication page and enter the username and password information received to log in.

If you are disconnected from the Internet during your visit, simply re-enter the credentials to access the campus wi-fi network. Please note – after 24 hours, you will need to create new credentials by following the steps listed above.

If you need assistance, call [559-278-5000](tel:559-278-5000) or visit the help desk website: <http://help.fresnostate.edu>.

### Acceptable Use of Eduroam

The use of Eduroam is governed by: [Eduroam policy and Fresno State's Acceptable Use Policy](#)

For guests to Fresno State, the Appropriate/Acceptable Use policy of your home organization also applies. Eduroam policy requires users of the service to either be over 18 years of age or have consent from a parent or guardian to use non-filtered Internet access. Login information is recorded by Fresno State and your home organization.

## About the SSRIC

Founded in 1972, the Council is the oldest of the disciplinary councils in the California State University system. With representatives from each of the CSU campuses, the Council is dedicated to assisting students and faculty in their learning, teaching, and research by:

- Providing a forum for sharing information about social science data and computer products;
- Initiating and conducting training programs;
- Recommending computerized social science projects in the CSU curriculum;
- Encouraging the collection and distribution of social science data and computer-related instructional and research materials;
- Advising CSU administrators on policies related to providing quantitative social science data for research and instruction;
- Supporting CSU student, faculty, and staff users of subscription data bases from the Inter-university Consortium for Political and Social Research (ICPSR), and the Roper Center, as well as of unrestricted data bases;
- Presenting Workshops on use of these data, as well as on SPSS, SDA, and other topics as needed;
- Organizing and sponsoring the annual SSRIC Social Science Student Symposium (S<sup>4</sup>); and
- Offering value-added teaching resources, including modules, exercises, and online textbooks.