



SOCIAL SCIENCE RESEARCH AND INSTRUCTIONAL COUNCIL

And

California State University

Present

The 42nd annual

Social Science Student Symposium (S⁴)

April 27, 2017

California State University, Fresno

Special thanks to the Department of Sociology, College of Social Sciences, and Sociology Club, CSU-Fresno

Registration and Welcoming Remarks

Time: 8:15-9:15

Location: Satellite Student Union

Registration: All presenters are required to check-in at the registration desk.

Light breakfast, and drinks to go, 8:15-9:15

(Drinks to go and light snacks available throughout the whole day.)

Welcoming Remarks, 8:30-9:15

Eugene Turner (retired), *Professor of Geography*, California State University, Northridge, and *Chair*, Social Science Research and Instructional Council

Michelle DenBeste, *Dean*, College of Social Science, California State University, Fresno

Tim Kubal, *Associate Professor of Sociology*, California State University, Fresno, and *Chair* of the symposium organizing committee

Session 1

Time: 9:30-10:45

Location: Multiple breakout rooms

Session Topics: Culture, Criminal Justice, Education, Politics, Health

Session 1A: Culture

9:30-10:45 University Student Union (USU), room 312

Presider/Discussant: Ed Nelson, Emeritus Professor of Sociology, CSU-Fresno

The Divinity of Jesus in Early Christian Thought: A Historiographical Approach

Joshua Tanis, History undergraduate student, CSU Stanislaus

The Power of Art in Prisons

Hannah Riccardi, Criminology undergraduate student, CSU-Fresno

Affrication in Qassimi Arabic

Alrashed Abdulmajeed, Linguistics graduate student, California State University, Fullerton

Social Interaction and Facebook Activity: Social Isolation as it Relates to Non-interaction

Joseph Dov, Sociology undergraduate student, California State University, Long Beach

Session 1B: Criminal Justice (Part 1)

9:30-10:45 University Student Union (USU), room 313

Presider/Discussant: Jenna Kieckhaefer, Assistant Professor of Criminology, California State University, Fresno

Public Perceptions of Exonerees from the Criminal Justice System
Shelby Elia, Public Administration graduate student, CSU
Fresno

AB 109 and How it Impacted California Criminal Justice System
Cheenou Xlong, Criminology undergraduate student, CSU
Fullerton

The Impact of Veteran's Mental Health and Offense Severity on Admissibility into Veterans Treatment Court
Samantha Luna, Criminology undergraduate student, CSU Fresno

Session 1C: Education (Part 1)

9:30-10:45 University Student Union (USU), room 314

Presider/Discussant: Nancy Hudspeth, Assistant Professor, CSU Stanislaus

Does Merit-Based Aid Influence Students' Tendencies to seek Graduate Degrees? A Statistical Analysis
Salahuddin Temueri, Political Science undergraduate student, CSU-San Francisco

Completing the graduate degree: the effect of student satisfaction with advisors on time to degree (TTD)
Ian Klinger, Sociology graduate student, CSU-Dominguez Hills

How does Income, Race, and Religion Affect Educational Levels of Attainment?
Murat Ince, Sociology undergraduate student, CSU-Fresno

School Finance Decisions and Academic Performance: An Analysis of the Impacts of School Expenditures on Student Performance
Andrew Carhart, Public Policy and Administration graduate student, CSU-Sacramento

Session 1D: Politics (Part 1)

9:30-10:45 Henry Madden Library, (HML) room 2127

Presider/ Discussant: Francis Neely, Professor of Political Science, San Francisco State University

The Myth of Cleopatra: Shrewd Sovereign or Wanton Woman

Rebecca Rooker, History Undergraduate Student, CSU-Stanislaus

Colonial Privateers: War and Trade During the American Revolution, 1775-1777

Edgar Bolanos History undergraduate student, CSU-Fresno

Hopes, Fears, and Expectations: The Ottoman Empire and the Outbreak of the First World War

Armen Manuk-Khaloyan, History Graduate Student, CSU-Northridge

America's Paradise Lost: The Abuse of Micronesia in the Name of Global Security

Taylor Trummel Political Science Undergraduate Student, CSU- San Diego

Session 1E: Health

9:30-10:45 Henry Madden Library (HML), room 2206

Presider/Discussant: Stafford Cox, Academic Technology Services, California State University Long Beach

Race, Education, and Socioeconomic Impact on Breastfeeding Mothers

Nicole Prekop, Sociology undergraduate student, CSU- Fresno

The Correlation between Religiosity and Adolescent Sexual Promiscuity

Ana Celestino, Health Sciences undergraduate student, CSU-Dominguez Hills

Cross-Cultural and Ethnical Differences and Similarities in Visual Attention among Japanese, Caucasian, and Hispanic Children

Candace Teran Health, Human Services, and Nursing undergraduate student CSU Dominguez Hills

Creating a Space to Call Their Own: Birth Workers of Color and Abuelita Knowledge in Los Angeles County.

Stevie Merino, Anthropology graduate student, CSU- Long Beach

Session 2

Time: 11:00-12:15

Location: Multiple breakout rooms

Session Topics: Family, Crime, Education, Politics, Race

Session 2A: Family

11:00-12:15 University Student Union (USU), room 312

Presider/Discussant: Jennifer Randles, Associate Professor of Sociology, CSU-Fresno

Mental Illness and the Foster Care System

Alexander S. Bony, Psychology undergraduate student, CSU-Fresno

Gendered Pairing Patterns in Interracial Marriages

Thais Forneret, Sociology graduate Student, CSU-Sacramento

Possible Associations between Perceived Parenting Behaviors and Adolescent Reliance on Religious Teachings

Gabriela Massie, Health Sciences undergraduate student, CSU-Dominguez Hills

Session 2B: Criminal Justice (Part 2)

11:00-12:15 University Student Union (USU), room 313

Presider/Discussant: Andrea Arndorfer, Assistant Professor, Department of Criminology, California State University, Fresno

The Association between Life Stress and Adolescent Substance Use

Emily Coviello, Health Sciences undergraduate student, CSU-Dominguez Hills

Golden State of Corrections: A County-by-County Analysis of Socioeconomic Factors on Incarceration and Recidivism Rates

Jordyn Markoe, Political Science undergraduate student, CSU-San Francisco

Police Structure and Staffing in Response to the 2007 Market Crash

Ernesto Lopez, Politics, Administration, and Justice graduate student, CSU-Fullerton

Masculinity and Law Enforcement in Fresno, CA

Cinthia Quesada, Sociology undergraduate student, CSU-Fresno

Session 2C: Education (Part 2)

11:00-12:15 University Student Union (USU), room 314

Presider/Discussant: Jenny Banh, Assistant Professor, CSU-Fresno

Social Factors Surrounding Sleep Among Fresno State Students

Chi Chang, Anthropology undergraduate student, CSU-Fresno

Student Talking About Race (S.T.A.R): An evaluation of the program

Tanjeem Afreen, Anthropology graduate student, CSU-Long Beach

The Undercurrent of Bohemian Grove, the Business of Diversity, and the Corporate (Post Affirmative Action) University: A Mix-Methods Discovery Expanding on the Theoretical Framework of (Subramanian, Perrucci and Whitlock's) Intellectual Closure (2014).

David Ortuno, Sociology Undergraduate Student, CSU San Marcos

The Effect of Student Satisfaction on Student Loan Default

Jennifer Skornik, Sociology graduate Student, CSU-Northridge

Session 2D: Politics (Part 2)

11:00-12:15 Henry Madden Library (HML), room 2127

Presider/ Discussant: Francis Neely, Professor of Political Science, San Francisco State University

Challenging the Stained Glass Ceiling: Exploring Political Participation among Women in the Evangelical Church

Rachael Cole, Sociology Graduate Student CSU-San Jose

"Youth, Globalization and Extremism in the Middle East" Advancing Data Science in Research, Analysis and Decision Making

Natascha Bolden, Political Science Graduate Student, CSU San Bernardino

The World's Panthers: Who the Black Panther Party Supported Abroad and Why

David Hollingsworth, History graduate student, CSU-San Diego

Session 2E: Race

11:00-12:15 Henry Madden Library (HML), room 2206

Presider/Discussant: Aya Ida, Professor of Sociology, California State University, Sacramento

Analyzing Race and Social Issues

Devany Prieto, Sociology undergraduate student, CSU-Fresno

The Racial Divide: Perceptions of Crime, the Death Penalty, Police Misconduct, Food Insecurity, and Economic Inequality

Amber Pinzon, Sociology undergraduate student, CSU-Fresno

The Continuum of Racial Discrimination Shaping American Lives Through Police Tactics, Immigration, Poverty, and Other Social Issues

Diana Arenivas, Sociology undergraduate student, CSU-Fresno

Race and Social Class Effects on Inequality, Homelessness, Crime, & Police

Elisa Ulloa, Biology undergraduate student, CSU-Fresno

Lunch and Keynote Address

Time: 12:30 -1:50

Location: Satellite Student Union (SSU)

Buffet Lunch, 12:15-1:15 (for presenters, presiders, and mentors)

Taco Bar (chicken or fish), salad, seafood and vegetarian appetizers, iced tea, coffee, dessert

Keynote address, 1:15-1:50

Mark DiCamillo is the former director of the Field Poll and is currently the director of the UC Berkeley Institute of Governmental Studies (IGS) Survey. He will be speaking on "The 2016 election and what it means for Polling."

Session 3

Time: 2:00-3:15

Location: Multiple breakout rooms

Topics: Demography, Psychology, Politics, Inequality

Session 3A: Demography

2:00-3:15, University Student Union (USU) 312

Presider/Discussant: Brian Gillespie, Assistant Professor of Sociology, Sonoma State University

The Creation of a Modern Estonian Identity: The Role of a Selective History, Ethnic Minorities, and Multilateral Organizations

Taylor Trummel, Political Science undergraduate, CSU- San Diego

Americans' Attitudes on Immigration

Aziz Waziri, Sociology undergraduate, CSU-Sacramento

What we know about the Hmong refugee crisis of decades past and how it can help us predict trends in the current Syrian refugee crisis.

Sheila Her, Political Science Undergraduate, CSU-Fresno

Session 3B: Psychology

2:00-3:15, University Student Union (USU) 313

Presider/Discussant: Aya Ida, Professor of Sociology, California State University, Sacramento

Diminished Levels of Personal Control in Lower Class Americans

Amanda Amaro, undergraduate student, Political Science, CSU-San Francisco

The Role of Heart Generated Electrical Activity in Decision-Making

Olivia Krieger Psychology Undergraduate Student, CSU- Sonoma

The Disappearance of the Middle Class and Political Efficacy in the United States

Amanda Amaro Political Science Undergraduate Student, CSU-San Francisco

Liberation Psychology: A Transpersonal Response to Systemic Oppression

Jodi Scofield Psychology Undergraduate Student CSU Los Angeles

Session 3C: Politics (Part 3)

2:00-3:15, University Student Union (USU) 314

Presider/Discussant: Melanie Ram, Associate Professor of Political Science, California State University, Fresno

WEARING THE PANTS: The Embodied Experiences of Women in the U.S. Coast Guard and Fire Service

Stephanie Chapman, Sociology undergraduate student, CSU-Sonoma

Preemptive Federalism: The Banking Dilemma Facing State Legal Marijuana Laws

Richard Kemp, Political Science graduate student, CSU Bakersfield

Feelings on Global Warming as Related to Income In The United States (2006-2012)

Guillermo Garcia Political Science Undergraduate Student, CSU- San Francisco

Session 3D: Politics (Part 4)

2:00-3:15, Henry Madden Library (HML) 2127

Presider/ Discussant: Francis Neely, Professor of Political Science, San Francisco State University

The Systematic Study of Leadership Selection in Congress

Cassandra Estrella, Political Science/ Global Studies undergraduate student, CSU-Channel Islands

Policy Networks and Democratic Governance

Ricardo Vieira, Political Science graduate student, CSU-San Diego

American Efficiency: The New United States Government

Alberto Mora, History undergraduate student, CSU-East Bay

Session 3E: Inequality

2:00-3:15, Henry Madden Library (HML) 2206

Presider/ Discussant: Matthew Jendian, Professor of Sociology, California State University, Fresno

Finding Inequality within Disability, Sex, and Unemployment

Political Science Undergraduate Student CSU San Francisco

Food Insecurity for Californians Living in Poverty: Racial, Transportation, and Geographic Correlates (2007)

Hannah Poore, Sociology undergraduate student, CSU-Fresno

Food Sustainability: Comparative Analysis Between Global and Local Distribution of Produce Items

Ariana Brandao Anthropology and Geography Undergraduate Student San Luis Obispo

Relationship Between Food Insecurity and Low-Income Seniors in Alameda County

Jeffrey Mosier Sociology Undergraduate Student CSU East Bay

-

Awards Ceremony and Closing Remarks

3:30-4:00

Satellite Student Union

Refreshments: Misc. desserts, lemonade, and coffee

Presentation of awards

Eugene Turner, *Professor of Geography* (retired), California State University, Northridge, and *Chair*, Social Science Research and Instructional Council

and

Gilbert Garcia, California State University, Los Angeles, *Chair*, Student Awards Committee, Social Science Research and Instructional Council

Closing remarks

Tim Kubal, Associate *Professor of Sociology*, California State University, Fresno, and *Chair* of the symposium organizing committee

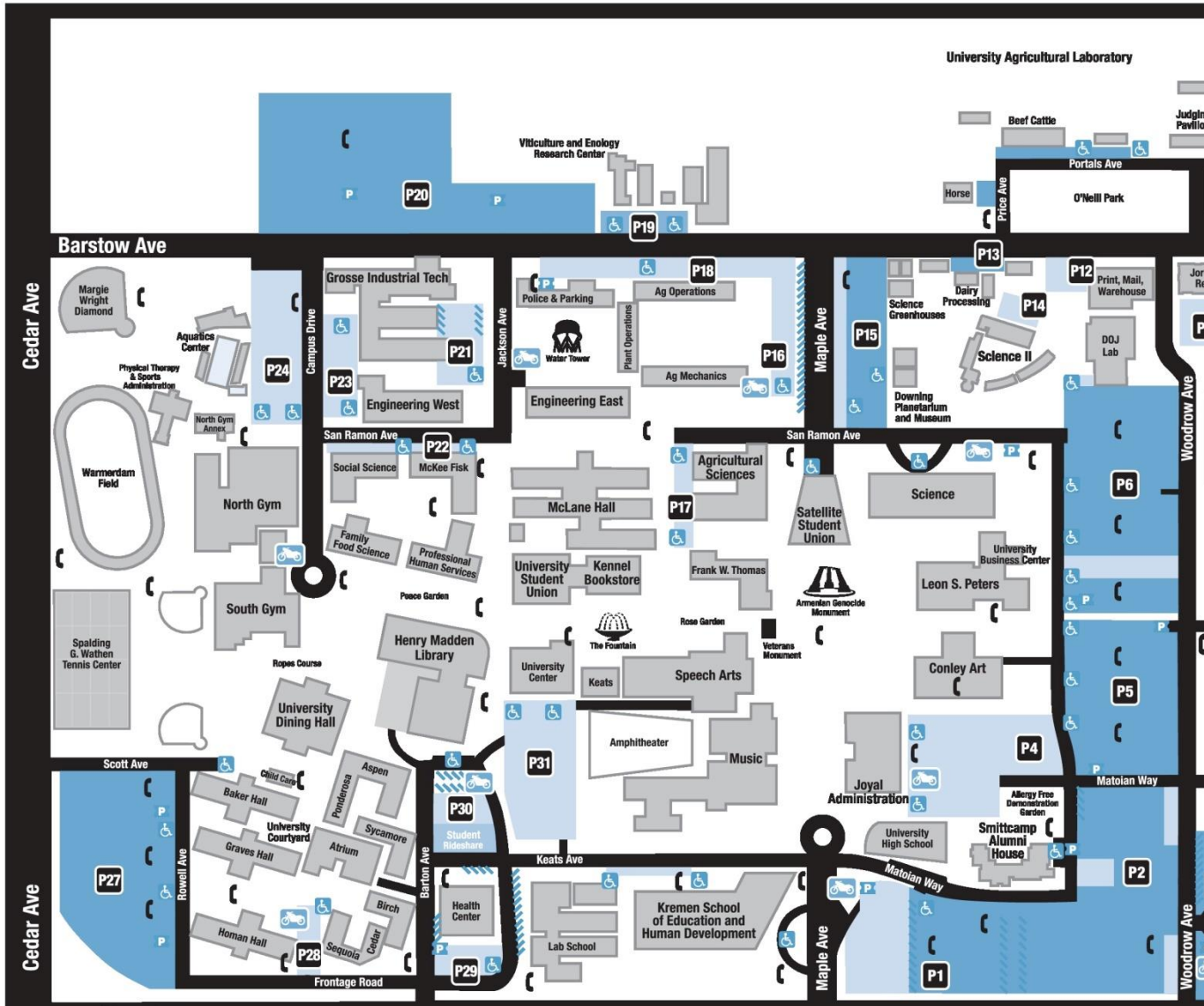

FRESNO STATE
Discovery. Diversity. Distinction.

Green Permit (Student/Visitor Parking)	Blue Permit (Disabled Parking)	Short Term Parking
Yellow Permit (Employee Parking)	Motorcycle Parking	Daily Parking Permit Dispensers

Internet Access for the 2017 Social Science Student Symposium

If you are an "Eduroam" user on your home campus, you should be able to connect to "Eduroam" on the Fresno State campus.

If you are not an "Eduroam" user, you will need to get a guest account on the Fresno State campus. Here are the instructions for doing that.

Creating a "One-day" Guest Account

Fresno State guests can create a temporary "one-day" wi-fi account to use while on campus.

1. On your device, select **Bulldogs** from the available Fresno State wi-fi networks.
2. Open a web browser and the authentication page will appear. If the authentication page does not appear, enter a common URL (e.g., msn.com) in the address bar and press **Enter** on your keyboard. The authentication page will appear afterwards.
3. Click on the "Need to register as a guest?" link located on the authentication page.
4. Fill out the request form. Be sure to include a valid cell phone number.
5. Click the **Register** button.
6. A text message with the account information is sent to the specified cell phone number.
7. Return to the Bulldogs authentication page and enter the username and password information received to log in.

If you are disconnected from the Internet during your visit, simply re-enter the credentials to access the campus wi-fi network. Please note – after 24 hours, you will need to create new credentials by following the steps listed above.

If you need assistance, call [559-278-5000](tel:559-278-5000) or visit the help desk website: <http://help.fresnostate.edu>.

Acceptable Use of Eduroam

The use of Eduroam is governed by: [Eduroam policy and Fresno State's Acceptable Use Policy](#)

For guests to Fresno State, the Appropriate/Acceptable Use policy of your home organization also applies. Eduroam policy requires users of the service to either be over 18 years of age or have consent from a parent or guardian to use non-filtered Internet access. Login information is recorded by Fresno State and your home organization.

About the SSRIC

Founded in 1972, the Council is the oldest of the disciplinary councils in the California State University system. With representatives from each of the CSU campuses, the Council is dedicated to assisting students and faculty in their learning, teaching, and research by:

- Providing a forum for sharing information about social science data and computer products;
- Initiating and conducting training programs;
- Recommending computerized social science projects in the CSU curriculum;
- Encouraging the collection and distribution of social science data and computer-related instructional and research materials;
- Advising CSU administrators on policies related to providing quantitative social science data for research and instruction;
- Supporting CSU student, faculty, and staff users of subscription data bases from the Inter-university Consortium for Political and Social Research (ICPSR), and the Roper Center, as well as of unrestricted data bases;
- Presenting Workshops on use of these data, as well as on SPSS, SDA, and other topics as needed;
- Organizing and sponsoring the annual SSRIC Social Science Student Symposium (S⁴); and
- Offering value-added teaching resources, including modules, exercises, and online textbooks.